

PREPARATION UNIT FOR POLYMERS

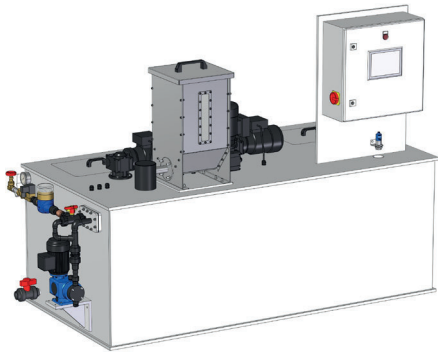

OVERVIEW

- Fully automatic preparation of organic flocculent aid (pulverized and/or liquid)
- Process logic control (PLC)
- Selectable concentration of prepared solution
- Feeding device
- Dry material feeder with thermal protection zone
- Pump for liquid polymer (option)
- Dissolving water unit
- Electric agitators
- Performance graduation that meets the requirements

TECHNICAL DATA

| DEFINITION of the types | | |
|-------------------------|-------------------|---|
| PolyLine ... S | S = solid | for preparation with polymer in powder form |
| PolyLine ... L | L = liquid | for preparation with liquid polymer |
| PolyLine ... SL | SL = solid/liquid | for preparation with polymer in powder form and/or liquid polymer |

| UNIT DATA | | PolyLine Flow 500 | PolyLine Flow 1000 | PolyLine Flow 2000 | PolyLine Flow 4000 | PolyLine Flow 8000 | |
|---|-----|-------------------|--------------------|--------------------|--------------------|--------------------|-----|
| Preparation capacity (at 45 min. maturing time) | l/h | 500 | 1.000 | 2.000 | 4.000 | 8.000 | |
| Weight (empty) | kg | S | 250 | 270 | 300 | 380 | 470 |
| | | L | 230 | 240 | 280 | 360 | 450 |
| | | SL | 270 | 290 | 340 | 410 | 520 |

| ELECTRICAL DATA | | PolyLine Flow ... S/L/SL |
|-------------------|------------------|--------------------------|
| Supply voltage | | ~3/400 V /Hz + N + PE |
| Power consumption | approx. kW | 2,0 |
| Control voltage | V DC | 24 |
| Enclosure | Control cabinet | IP 54 |
| | electr. consumer | IP 55 |

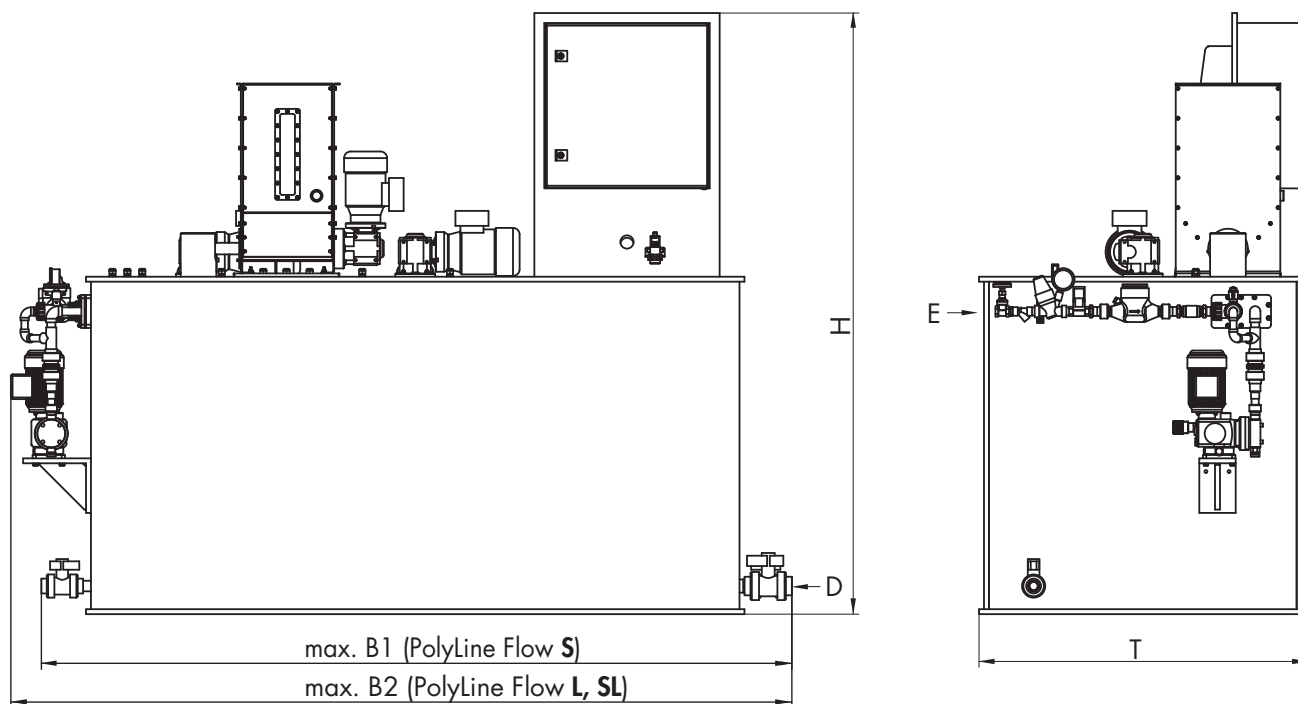
DIMENSIONS

| | B1 | B2 | T | H* | D | E |
|---------------------|-------|-------|-------|-------|------|------|
| PolyLine® Flow 500 | 2.240 | 2.340 | 990 | 1.550 | DN25 | DN15 |
| PolyLine® Flow 1000 | 2.240 | 2.340 | 990 | 1.550 | DN25 | DN15 |
| PolyLine® Flow 2000 | 2.270 | 2.360 | 990 | 1.820 | DN32 | DN15 |
| PolyLine® Flow 4000 | 3.310 | 3.390 | 1.280 | 2.110 | DN40 | DN25 |
| PolyLine® Flow 8000 | 4.330 | 4.470 | 1.570 | 2.330 | DN50 | DN25 |

* depending on the height of the dry material feeder (DMF)

PREPARATION UNIT FOR POLYMERS

BASIC DESIGNS

PolyLine Flow S

3-Chamber tank made of PP
Control (PLC) for fully automatic preparation
Dry material feeder (DMF) with hopper, 25 liters
Feeding device
2x electric agitator (low speed)
Level monitoring
Dissolving water unit
Language on display de/en

| Type | Article-No. | Price (EUR) |
|----------------------|-------------|-------------|
| PolyLine Flow 500 S | 25004493 | ▲ |
| PolyLine Flow 1000 S | 25004595 | ▲ |
| PolyLine Flow 2000 S | 25004528 | ▲ |
| PolyLine Flow 4000 S | 25004531 | ▲ |
| PolyLine Flow 8000 S | 25004534 | ▲ |

PolyLine Flow L

3-Chamber tank made of PP
Control (PLC) for fully automatic preparation
Dosing pump for liquid polymer
Feeding device
2x electric agitator (low speed)
Level monitoring
Dissolving water unit
Language on display de/en

| Type | Article-No. | Price (EUR) |
|----------------------|-------------|-------------|
| PolyLine Flow 500 L | 25004523 | ▲ |
| PolyLine Flow 1000 L | 25004526 | ▲ |
| PolyLine Flow 2000 L | 25004529 | ▲ |
| PolyLine Flow 4000 L | 25004532 | ▲ |
| PolyLine Flow 8000 L | 25004535 | ▲ |

PolyLine Flow SL

3-Chamber tank made of PP
Control (PLC) for fully automatic preparation
Dry material feeder (DMF) with hopper, 25 liters
Dosing pump for liquid polymer
Feeding device
2x electric agitator (low speed)
Level monitoring
Dissolving water unit
Language on display de/en

| Type | Article-No. | Price (EUR) |
|-----------------------|-------------|-------------|
| PolyLine Flow 500 SL | 25004524 | ▲ |
| PolyLine Flow 1000 SL | 25004527 | ▲ |
| PolyLine Flow 2000 SL | 25004530 | ▲ |
| PolyLine Flow 4000 SL | 25004533 | ▲ |
| PolyLine Flow 8000 SL | 25004536 | ▲ |

OPTIONS

| Option | Type | | Price [EUR] |
|---|----------|--|-------------|
| 3 rd Agitator | S, L, SL | chamber volume 500 - 2.000 litres | ▲ |
| | | chamber volume 4.000 - 8.000 litres | ▲ |
| Low-level indicator for hopper | S, SL | (for DMF) | ▲ |
| Hopper Extension | S, SL | (for DMF) expansion of volume: 25 litres | ▲ |
| Hopper extension + High level indicator for hopper | S, SL | (for DMF) | ▲ |
| Electric external vibrator | S, SL | (for DMF) 0,045kW, 230V, 50Hz, IP65, ISO-Kl. F | ▲ |
| Hopper loader | S, SL | incl. hose package and suction pipe | ▲ |
| Overflow | S, L, SL | chamber volume 500 - 2.000 litres | ▲ |
| | | chamber volume 4.000 litres | ▲ |
| Overflow protection | S, L, SL | | ▲ |
| Operating panel | S, L, SL | TOUCH Display with Touchscreen - de/en | ● |
| | | Language other languages possible | Ⓞ |
| Signal exchange package | S, L, SL | | ▲ |
| BUS-Connection | S, L, SL | PROFIBUS DP/Slave | ▲ |
| | | industrial ethernet | ▲ |
| Special voltage | S, L, SL | for control and other electrical consumers | Ⓞ |

ACCESSORIES

| | | Price [EUR] | |
|------------------------|---|---------------------------|---|
| After-dilution station | Dilution of the preparation in a ratio of 1:10 | 2...6 m ³ / h | ▲ |
| | | 5...12 m ³ / h | ▲ |
| | | 8...20 m ³ / h | ▲ |

PREPARATION UNIT FOR POLYMERS

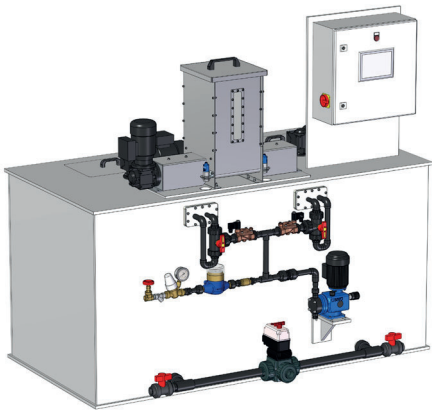

OVERVIEW

- Fully automatic preparation of organic flocculent aid (pulverized and/or liquid)
- Process logic control (PLC)
- Selectable concentration of prepared solution
- Feeding device
- Dry material feeder with thermal protection zone
- Pump for liquid polymer (option)
- Dissolving water unit
- Electric agitators
- Performance graduation that meets the requirements

TECHNICAL DATA

| DEFINITION of the types | | |
|-------------------------|-------------------|---|
| PolyLine ... S | S = solid | for preparation with polymer in powder form |
| PolyLine ... L | L = liquid | for preparation with liquid polymer |
| PolyLine ... SL | SL = solid/liquid | for preparation with polymer in powder form and/or liquid polymer |

| UNIT DATA | | PolyLine Swing 500 | PolyLine Swing 1000 | PolyLine Swing 2000 | PolyLine Swing 4000 | |
|---|-----|--------------------|---------------------|---------------------|---------------------|-----|
| Preparation capacity (at 30 min. maturing time) | l/h | 500 | 1.000 | 2.000 | 4.000 | |
| Weight (empty) | kg | S | 240 | 240 | 280 | 460 |
| | | L | 230 | 230 | 260 | 440 |
| | | SL | 260 | 260 | 295 | 480 |

| ELECTRICAL DATA | | PolyLine Swing ... S/L/SL |
|-------------------|------------------|---------------------------|
| Supply voltage | | ~3/400 V /Hz + N + PE |
| Power consumption | approx. kW | 2,0 |
| Control voltage | V DC | 24 |
| Enclosure | control cabinet | IP 54 |
| | electr. consumer | IP 55 |

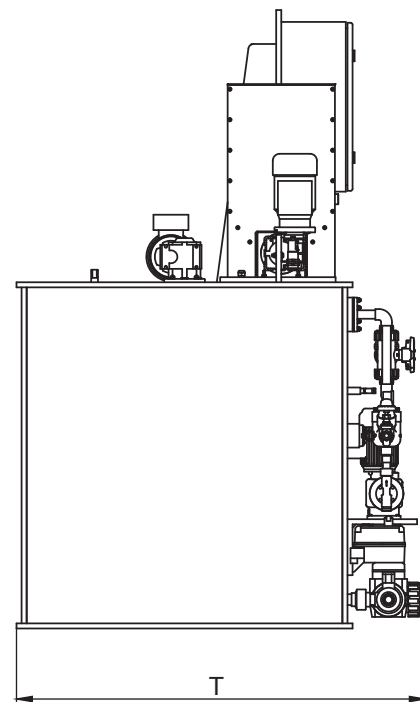
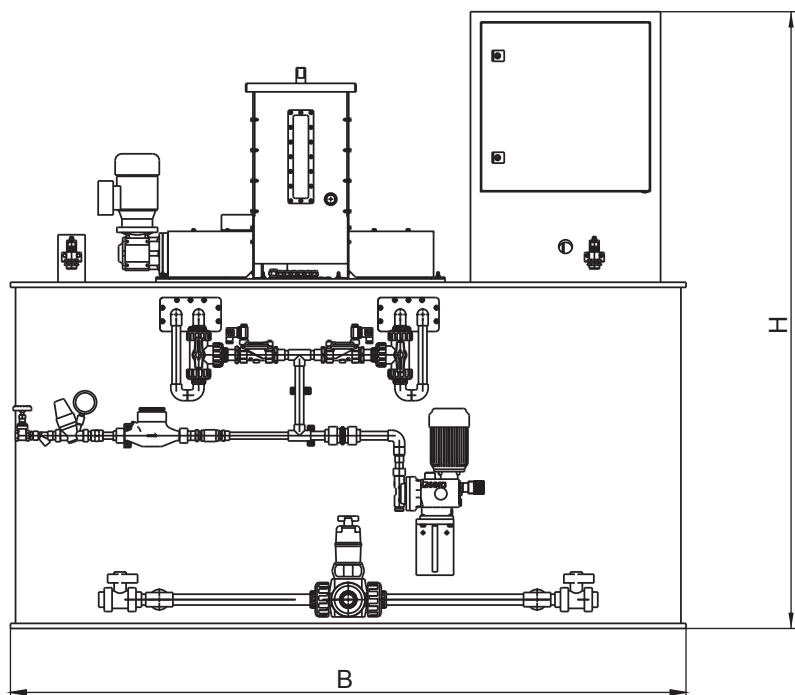
DIMENSIONS

| | B | T | H* | D | E |
|----------------------|-------|-------|-------|------|------|
| PolyLine® Swing 500 | 1.990 | 1.210 | 1.550 | DN25 | DN15 |
| PolyLine® Swing 1000 | 1.990 | 1.220 | 1.820 | DN32 | DN15 |
| PolyLine® Swing 2000 | 2.990 | 1.520 | 2.110 | DN40 | DN25 |
| PolyLine® Swing 4000 | 4.000 | 1.820 | 2.330 | DN50 | DN25 |

* depending on the height of the dry material feeder (DMF)

PREPARATION UNIT FOR POLYMERS

BASIC DESIGNS

PolyLine Swing S

2-Chamber tank made of PP
Control (PLC) for fully automatic preparation
Dry material feeder (DMF) with hopper, 25 liters
Feeding device
2x electric agitator (low speed)
2x Level monitoring
Dissolving water unit
Language on display de/en

| Type | Price (EUR) |
|-----------------------|-------------|
| PolyLine Swing 500 S | Ⓞ |
| PolyLine Swing 1000 S | Ⓞ |
| PolyLine Swing 2000 S | Ⓞ |
| PolyLine Swing 4000 S | Ⓞ |

PolyLine Swing L

2-Chamber tank made of PP
Control (PLC) for fully automatic preparation
Dosing pump for liquid polymer
Feeding device
2x electric agitator (low speed)
2x Level monitoring
Dissolving water unit
Language on display de/en

| Type | Price (EUR) |
|-----------------------|-------------|
| PolyLine Swing 500 L | Ⓞ |
| PolyLine Swing 1000 L | Ⓞ |
| PolyLine Swing 2000 L | Ⓞ |
| PolyLine Swing 4000 L | Ⓞ |

PolyLine Swing SL

2-Chamber tank made of PP
Control (PLC) for fully automatic preparation
Dry material feeder (DMF) with hopper, 25 liters
Dosing pump for liquid polymer
Feeding device
2x electric agitator (low speed)
2x Level monitoring
Dissolving water unit
Language on display de/en

| Type | Price (EUR) |
|------------------------|-------------|
| PolyLine Swing 500 SL | Ⓞ |
| PolyLine Swing 1000 SL | Ⓞ |
| PolyLine Swing 2000 SL | Ⓞ |
| PolyLine Swing 4000 SL | Ⓞ |

OPTIONS

| Option | Type | | Price [EUR] |
|--|----------|--|-------------|
| Low-level indicator for hopper | S, SL | (for DMF) | ▲ |
| Hopper Extension | S, SL | (for DMF) expansion of volume: 25 litres | ▲ |
| Hopper extension + High level indicator for hopper | S, SL | (for DMF) | ▲ |
| Electric external vibrator | S, SL | (for DMF) 0,045kW, 230V, 50Hz, IP65, ISO-Kl. F | ▲ |
| Hopper loader | S, SL | incl. hose package and suction pipe | ▲ |
| Overflow | S, L, SL | chamber volume 500 - 2.000 litres | ▲ |
| | | chamber volume 4.000 litres | ▲ |
| Overflow protection | S, L, SL | | ▲ |
| Operating panel | S, L, SL | TOUCH Display with Touchscreen - de/en | ● |
| | | language other languages possible | Ⓞ |
| Signal exchange package | S, L, SL | | ● |
| BUS-Connection | S, L, SL | PROFIBUS DP/Slave | ▲ |
| | | Ind. Ethernet | ▲ |
| Special voltage | S, L, SL | for control and other electrical consumers | Ⓞ |

ACCESSORIES

| | | Price [EUR] | |
|------------------------|--|---------------------------|---|
| After-dilution station | Dilution of the preparation in a ratio of 1:10 | 2...6 m ³ / h | ▲ |
| | | 5...12 m ³ / h | ▲ |
| | | 8...20 m ³ / h | ▲ |

PREPARATION UNIT FOR POLYMERS

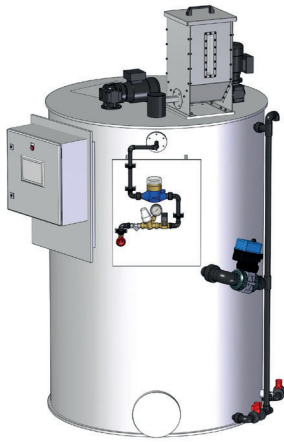

OVERVIEW

- Fully automatic preparation of organic flocculent aid (pulverized and/or liquid)
- Process logic control (PLC)
- Selectable concentration of prepared solution
- Feeding device
- Dry material feeder with thermal protection zone
- Pump for liquid polymer (option)
- Dissolving water unit
- Electric agitator
- Performance graduation that meets the requirements

TECHNICAL DATA

| DEFINITION of the types | | |
|-------------------------|-------------------|---|
| PolyLine ... S | S = solid | for preparation with polymer in powder form |
| PolyLine ... L | L = liquid | for preparation with liquid polymer |
| PolyLine ... SL | SL = solid/liquid | for preparation with polymer in powder form and/or liquid polymer |

| UNIT DATA | | | PolyLine Double 500 | PolyLine Double 1000 | PolyLine Double 2000 |
|---|-----|----|---------------------|----------------------|----------------------|
| Preparation capacity (at 45 min. maturing time) | l/h | | 500 | 1.000 | 2.000 |
| Weight (empty) | kg | S | 200 | 240 | 325 |
| | | L | 160 | 200 | 285 |
| | | SL | 210 | 250 | 335 |

| ELECTRICAL DATA | | PolyLine Double ... S/L/SL |
|-------------------|------------------|----------------------------|
| Supply voltage | | ~3/400 V /Hz + N + PE |
| Power consumption | approx. kW | 2,0 |
| Control voltage | V DC | 24 |
| Enclosure | control cabinet | IP 54 |
| | electr. consumer | IP 55 |

DIMENSIONS

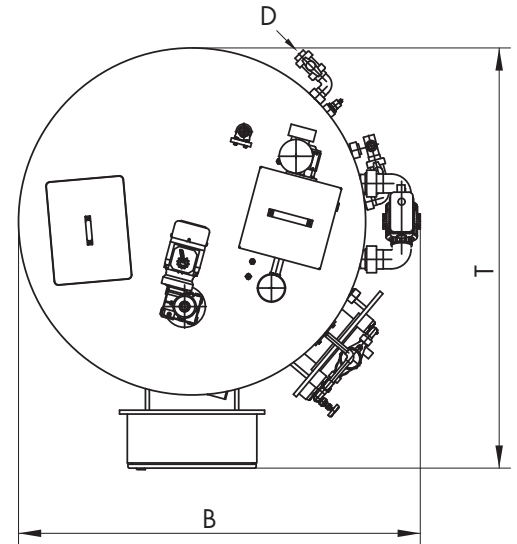
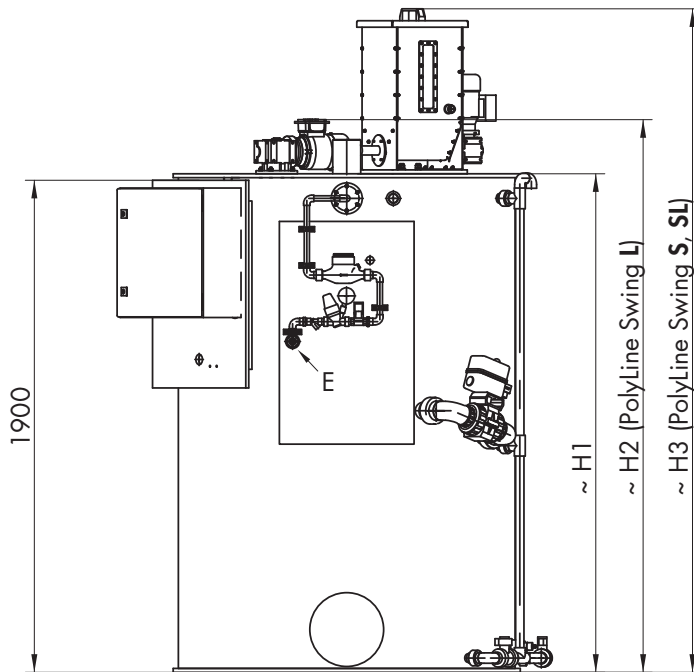

| | B | T | H1 | H2 | H3* | D | E |
|-----------------------|-------|-------|-------|-------|-------|------|------|
| PolyLine® Double 500 | 1.320 | 1.420 | 1.370 | 1.570 | 2.000 | DN25 | DN15 |
| PolyLine® Double 1000 | 1.560 | 1.630 | 1.925 | 2.140 | 2.570 | DN25 | DN15 |
| PolyLine® Double 2000 | 2.020 | 2.180 | 1.900 | 2.130 | 2.540 | DN32 | DN15 |

* depending on the height of the dry material feeder (DMF)

PREPARATION UNIT FOR POLYMERS

BASIC DESIGNS

PolyLine Double S

2-Chamber tank made of PP
Control (PLC) for fully automatic preparation
Dry material feeder (DMF) with hopper, 25 liters
Feeding device
Electric agitator (low speed)
Level monitoring
Dissolving water unit
Language on display de/en

| Type | Article-No. | Price (EUR) |
|------------------------|-------------|-------------|
| PolyLine Double 500 S | 25004537 | ▲ |
| PolyLine Double 1000 S | 25004540 | ▲ |
| PolyLine Double 2000 S | 25004543 | ▲ |

PolyLine Double L

2-Chamber tank made of PP
Control (PLC) for fully automatic preparation
Dosing pump for liquid polymer
Feeding device
Electric agitator (low speed)
Level monitoring
Dissolving water unit
Language on display de/en

| Type | Article-No. | Price (EUR) |
|------------------------|-------------|-------------|
| PolyLine Double 500 L | 25004538 | ▲ |
| PolyLine Double 1000 L | 25004541 | ▲ |
| PolyLine Double 2000 L | 25004544 | ▲ |

PolyLine Double SL

2-Chamber tank made of PP
Control (PLC) for fully automatic preparation
Dry material feeder (DMF) with hopper, 25 liters
Dosing pump for liquid polymer
Feeding device
Electric agitator (low speed)
Level monitoring
Dissolving water unit
Language on display de/en

| Type | Article-No. | Price (EUR) |
|-------------------------|-------------|-------------|
| PolyLine Double 500 SL | 25004539 | ▲ |
| PolyLine Double 1000 SL | 25004542 | ▲ |
| PolyLine Double 2000 SL | 25004545 | ▲ |

OPTIONS

| Option | Type | | Preis [EUR] |
|--|----------|--|-------------|
| Low-level indicator for hopper | S, SL | (for DMF) | ▲ |
| Hopper Extension | S, SL | (for DMF) Erweiterung des Volumens: 25 Liter | ▲ |
| Hopper extension + High level indicator for hopper | S, SL | (for DMF) | ▲ |
| Electric external vibrator | S, SL | (for DMF) 0,045kW, 230V, 50Hz, IP65, ISO-Kl. F | ▲ |
| Hopper loader | S, SL | incl. hose package and suction pipe | ▲ |
| Overflow protection | S, L, SL | | ▲ |
| Operating panel | S, L, SL | TOUCH Display with Touchscreen - de/en | ● |
| | | language other languages possible | ⌚ |
| Signal exchange package | S, L, SL | | ● |
| BUS-Connection | S, L, SL | PROFIBUS DP/Slave | ▲ |
| | | industrial Ethernet | ▲ |
| Special voltage | S, L, SL | for control and other electrical consumers | ⌚ |

ACCESSORIES

| | | Price [EUR] | |
|------------------------|--|---------------------------|---|
| After-dilution station | Dilution of the preparation in a ratio of 1:10 | 2...6 m ³ / h | ▲ |
| | | 5...12 m ³ / h | ▲ |
| | | 8...20 m ³ / h | ▲ |